

TECHNICAL DATA

REFUSE COMPACTOR

BC 873 RB-5, BC 973 RB-5, BC 1173 RB-5

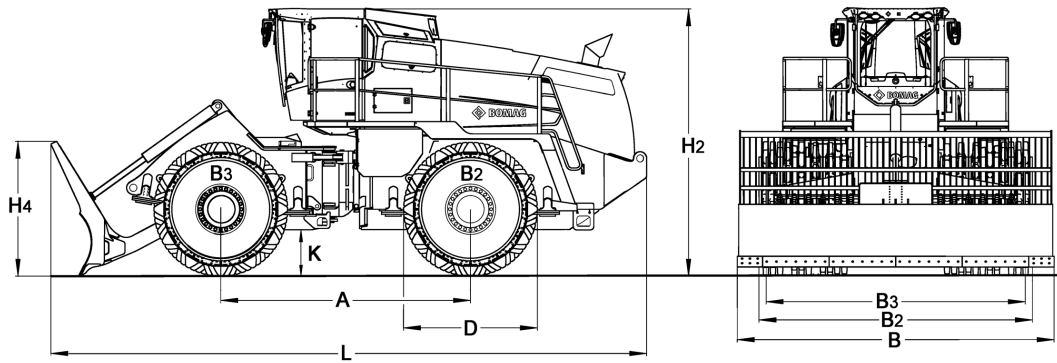



Dimensions in in

	A	B	B2	B3	D	H2	H4	K	L
BC 873 RB-5	161.8	178.7	158.7	149.4	84.6	172.2	87.6	29.1	385.0
BC 973 RB-5	161.8	204.7	177.2	167.9	86.6	173.2	90.0	30.1	385.0
BC 1173 RB-5	161.8	204.7	177.2	167.9	86.6	173.2	90.0	30.1	385.0

Shipping dimensions in cub.yd

BC 873 RB-5	253,887
BC 973 RB-5	292,515
BC 1173 RB-5	292,515

Technical Data

BOMAG BC 873 RB-5

BOMAG BC 973 RB-5

BOMAG BC 1173 RB-5

Weights

Grossweight	lb	93,256	106,925	126,546
Operating weight CECE	lb	91,933	105,602	124,782

Driving Characteristics

Speed (1), forward	mph	0- 7.5	0- 7.5	0- 7.5
Speed (1), reverse	mph	0- 7.5	0- 7.5	0- 7.5
Max. gradeability (dep. on soil con.) .	%	100	100	100
Max. pushing force	lb	448	502	613

Drive

Engine manufacturer		Cummins	Cummins	Cummins
Type		X15	X15	X15
Emission stage		Stage V / TIER4f	Stage V / TIER4f	Stage V / TIER4f
Exhaust gas aftertreatment		DOC+DPF+SCR	DOC+DPF+SCR	DOC+DPF+SCR
Cooling		Liquid	Liquid	Liquid
Number of cylinders		6	6	6
Gross power SAE J 1995	hp	450.6	575.3	575.3
Gross power SAE J 1995	hp	456.0	575.0	575.0
Performance SAE J 1349	hp	456.0	576.0	575.0
Speed	rpm	1,700	1,700	1,700
Travel system		hydrost.	hydrost.	hydrost.
Operating voltage	V	24	24	24

Compaction Wheels

Width, front	in	47.2	55.1	55.1
Width, rear	in	47.2	55.1	55.1
Number of teeth/cutters, front		60	72	72
Number of teeth/cutters, rear		60	72	72
Compaction coverage per side	in	52.0	59.8	59.8

Brakes

Service brake		hydrost.	hydrost.	hydrost.
Parking brake		hydromec.	hydromec.	hydromec.

Steering

Steering system		oscil.artic.	oscil.artic.	oscil.artic.
Steering method		hydraulic	hydraulic	hydraulic
Track radius, inner	in	137.5	129.6	129.6
Steering / oscillating angle +/-	deg	40/15.0	40/15.0	40/15.0

Dozer Blade

Height adjustment over ground level .	in	54.1	54.1	54.1
Height adjustment below ground level	in	2.0	2.0	2.0
Dozer blade capacity acc. to SAE J 1265	cub.yd	18.0	20.7	20.7

Capacities

Fuel	gal	258.9	258.9	258.9
Engine oil	gal	12.4	12.4	12.4
Hydraulic oil	gal	155.9	155.9	155.9
AdBlue (DEF) ®	gal	26.4	26.4	26.4

Technical modifications reserved. Machines may be shown with options.

Standard Equipment

Optional Equipment

- Polygonal compaction wheels, velded forged teeth
- Premium compaction wheels with highly wear resistant teeth
- Pre start cabin heating
- Fire extinguisher
- Special painting
- Protective ventilation system (Pre-installation)
- Tool kit
- Semi-U-Blade 206.5in
- Cold start device 115V
- Cold start device 230V
- TELEMATIC POWER

